

Yavapai Library Network

Monthly Report January 2013

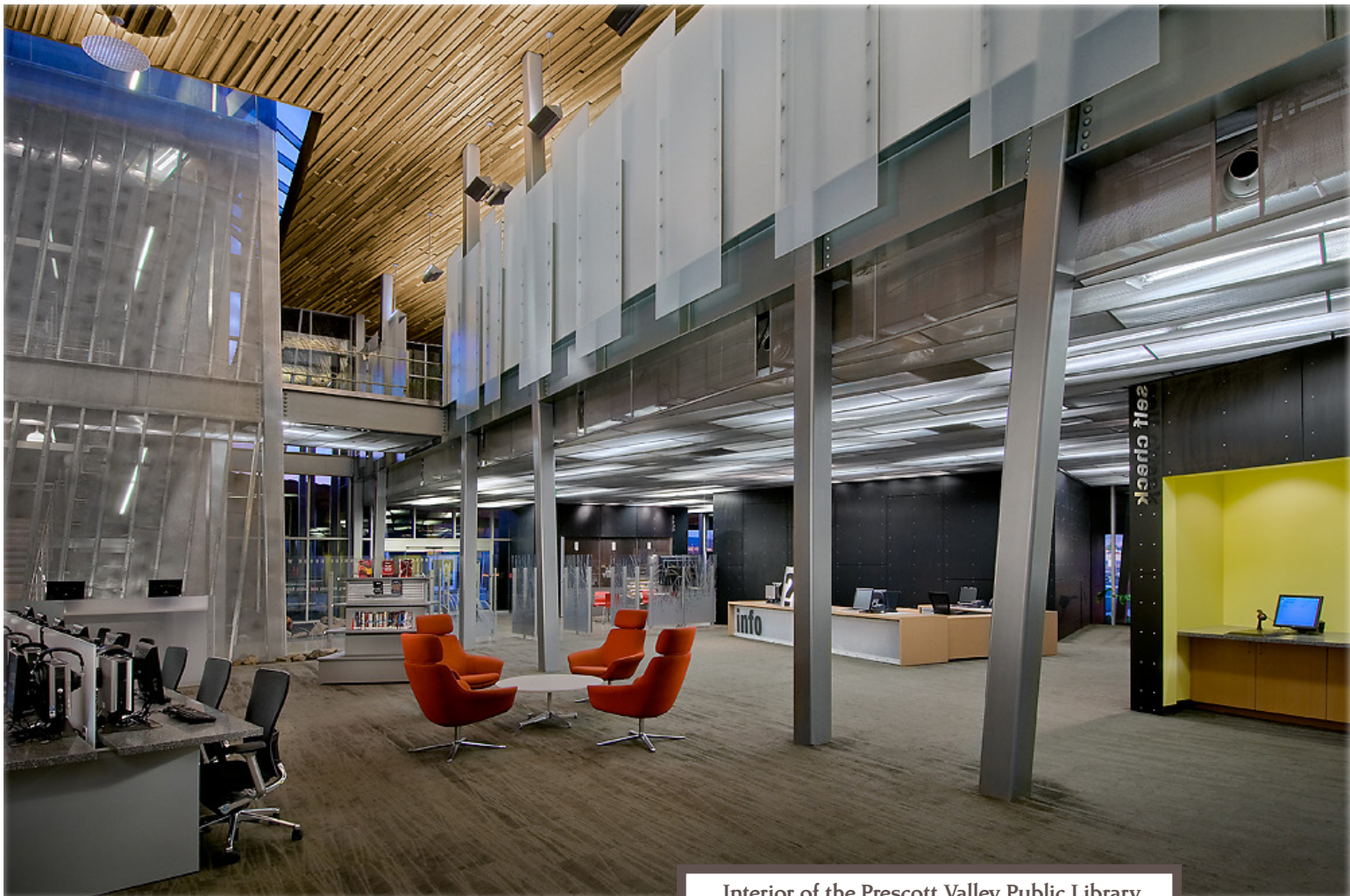

Interior of the Prescott Valley Public Library

Library Network Manager's Lowdown

The first month of 2013 saw the completion of several long-term projects that we at the YLN have been working on. The first group of these were several policies that were put into effect at the last management meeting. They are available on the portal (Intranet → Administration → Policies).

The first of these policies is the data retention policy. It was implemented hastily to make sure the YLN is in compliance with Arizona statute with regards to data retention. The formal policy was approved this month. The next policy concerns patron privacy and the retention of circulation history. Lastly, a policy was adopted concerning the ethics of modifying a patron's record. My hope is that these policies will give YLN members a clear view of what is expected of them in these areas. Also, a committee is being formed that will deal with policy concerning circulation and cataloging as well.

Another completed project was the final approval of the YLN Technology Plan. The plan was written for the next five years and addresses several technical areas including the potential purchase of a new Integrated Library System and full implementation and integration of the Student Information System for the academics.

A key decision was also made at the last management committee meeting to switch from a Universal Card system (a single-card system) to a three-card system. Each library type (academic, K-12, and public) will have their own set of patrons. They will not be separated out in the patron database and every member library will still be able to see each patron. The real difference is the potential now exists for a single patron to have three different library cards. This change was necessary to fully implement the Student Information System (SIS) project.

The FY2012-2013 billing amounts were prepared and made public at the last Management Committee meeting as well. If you did not attend the meeting and would like to know what you are going to be billed before the letter is sent please let me know. Each library's governing authority will be sent their bill in March. All bills will be paid to the Yavapai County Free Library District.

Another look at the special collections is going to take place. Member libraries have taken stewardship of each special collection. Some members have taken responsibility for several special collections and are having difficulty keeping up. The Prescott College Library has taken over stewardship of the ECOSA Institute special collection. The YCFLD is taking a look at the Prescott Veteran's Administration Library and the court library to see if they can take over stewardship of these special collections. Talks have commenced with the court library.

Barbara Kile and I attended the ALA Midwinter conference. We spent most of our time meeting with ILS vendors to take a look at the current state of the marketplace. The good news is if we decide to replace Symphony there are many viable alternatives.

Respectfully Submitted,



Corey Christians

Library Network Manager



Priority One: Resolve Current Helpdesk Requests

A help desk request, or work order, is a problem that one encounters during normal operation if a YLN service. Requests are generally submitted via e-mail to help@yln.info. If a request is submitted via telephone than a YLN staff person will create the request for the submitter. Help desk requests will always be our highest priority because in some cases a member library employee cannot complete a work function until the issue is resolved.

- Total requests submitted in January: 103**
- Total requests closed in January: 102**
- Total unresolved requests opened in January: 4**
- Total requests still open: 53**

Priority Two: Expand Telemessage Access

The Telemessage (Itiva) system notifies library users via the telephone if they have an overdue item or an available hold. Library users can also call in an renew items, find out their bills, or just see what they have out. Currently this service is only available for PPL and PVPL.

Goal: Upgrade and expand the Telemessage service to include all public libraries within the local calling area in Cottonwood and Prescott that desire the service.

Project Lead: Jim Lowman

Progress:

- Upgrade server to Windows 2008 (1/30/13)
- Upgrade Telemessage to the latest version (1/30/13)
- Determine county telephone accessibility
- Transfer phone service to the county system
- Add additional libraries
- Advertise new service

Priority Three: Add Additional Libraries

SirsiDynix has significantly reduced the cost of adding a library. The reduction in cost allows the YLN to add additional libraries. An LSTA grant will be pursued to add those libraries which desire YLN membership.

Goal: Pursue an LSTA grant to cover startup costs for libraries joining the YLN.

Project Lead: Corey Christians

Progress:

- Attend the LSTA workshop. (1/16/13)
- Reach out to new potential members.
- Get a letter from potential members.
- Fill out the appropriate LSTA grant information.
- Get for adding the new members.
- Configure and add new libraries..

Priority Four: Vufind Implementation

Write something here.

Goal: Release a production version of VuFind by July 2013.

Project Lead: Chanel Wheeler

Progress:

- Install VuFind 2
- Learn about VuFind 2 framework
- Customize VuFind 2 to include elibrary functionality
- Go live on VuFind 2

Note concerning prioritization: The priority of projects may shift as individual portions are completed.



Priority Five: YLN Strategic Plan

While the YLN has been very good about technology planning the overall vision and strategy of the YLN has been more elusive. The Executive Committee has been working on developing a vision, mission, and strategic plan.

Goal: Develop a strategic plan that will bring the YLN to the year 2020.

Project Lead: Corey Christians

Progress:

- Develop a survey to send out to the membership.
- Use the results to make a list of discussion areas
- Start brainstorming about strategy/mission/vision
- Develop a final strategic plan
- Get approval of the plan

Priority Six: SIS Integration

School and academic institutions have a student information system (SIS) that contains all the information about their students. Importing this information into Symphony will save time for library staff.

Goal: Automate the export/import of student data from academic and school institutions.

Project Lead: Chanel Wheeler

Progress:

- Determine the data needs of the K-12 libraries
- Develop a plan to import student data
- Train K-12 library staff on the new plan
- Determine the needs of academic libraries
- Get approval of three-card system
- Observe use of student IDs/library cards at academic library circulation desks
- Design a viable SIS import automation solution
- Get academic libraries' feedback on the solution
- Work with academic IT departments for data format
- Create data mapping script
- Test data import
- Automate the process

Priority Seven: Member Billing

The appropriate statistics have to be applied to the formula to determine what each member will pay. All payments will be applied to our reserve. The bill should be sent by March 15th.

Goal: Determine what each library should pay and draft a letter for billing.

Project Lead: Corey Christians

Progress:

- Compile the annual statistics
- Plug the appropriate statistics into the formula
- Notify Network libraries what their bill will be
- Draft a letter to go with the bill
- Send out the bill (YCFLD sends the bill)

Priority Eight: Separate Policies and Procedures

Currently policies and procedures are integrated in the circulation and cataloging manuals. The combination has led to some confusion regarding the purpose of the manuals.

Goal: Create two distinct documents that detail policies and procedures.

Project Lead: Corey Christians

Progress:

- Create a joint subcommittee with representatives from circulation, cataloging, and public services.
- Have the committee determine what are policies and what are procedures
- Draft two different documents.
- Get approval from each user group and the network steering committee



Priority Ten: Implement SMS features into the ILS

Cell phone texting features need to be added to Symphony. This will allow library users to get messages regarding the library account to their mobile phone.

Goal: Implement SMS functionality in Symphony.

Project Lead: Corey Christians

Progress:

- Purchase an SMS bundle from SirsiDynix
- Enable SMS features in Symphony
- Create documentation
- Train staff on how to use the new feature
- Publicize the new feature

Priority Eleven: Replace Blue Sockets for YCFLD libraries

Replace all existing networking controllers with a new network controller running over a virtual network. This will reduce network and support costs for the YCFLD libraries.

Goal: Simplify the network of the YCFLD libraries.

Project Lead: Jim Lowman

Progress:

- Determine if the new solution will work in our networking environment.
- Purchase the new device
- Set up a test network
- Remove each existing networking device

Completed Projects

- Created the YLN data retention, privacy, and ethics policy
- Took an initial look at ILS vendors
- Created the YLN Technology Plan
- Upgraded Telemessage software to the latest version



Statistics



Holds - January 2013					
Pickup Library	All	CANCELLED	EXPIRED	FILLED	EXP_ONSHELF
All	35200	3665	14	29523	1998
AJS	406	42		360	4
ASH	176	8	1	157	10
BAG	192	29		155	8
BCC	488	29		447	12
BMHS	99	27		72	
CLA	143	9		130	4
CON	465	49		397	19
COR	354	33		302	19
CRK	22			21	1
CTW	3303	340	3	2762	198
CVHS	37	8		28	1
CVPL	2403	163		2112	128
CVUSD	87	3		48	36
DHL	456	21		425	10
DIAL	6	1		4	1
ERU	260	64		189	7
GMMS	25			24	1
JER	121	5		116	
LES	9	2		7	
MAY	515	48		439	28
MVS	7			7	
ORME	51	3		44	4
PCL	353	40		298	15
PCT	1				1
PHS	216	44	3	163	6
PMH	45			43	2
PPL	10700	1231	1	8769	699
PPLA	334	20		313	1
PVPL	6404	756	3	5222	423
SED	3003	284	2	2566	151
SEL	458	13		397	48
THS	29	1		27	1
VBC	396	51		328	17
VER	1052	97		910	45
VOC	1482	147		1313	22
WIL	102	6		89	7
WTS	66	15		46	5
YAR	365	21		340	4
YCP	465	48		366	51
YCV	75	3	1	67	4
YFL	29	4		20	5



Statistics



Items Transited by Library for January 2013

Station Library →

Item Library ↓	All	AJS	ASH	BAG	BCC	BMHS	CLA	CON	COR	CRK	CTW	CVHS	CVPL	CVUSD	DHL	DIAL	ERU
All		356	159	142	431	76	110	330	299	14	2225	25	1982	77	390	4	218
AJS	77			1	1			1			10		9	3	6		1
ASH	238	2		1	3		3	4	3		20	1	24		7		3
BAG	370	2	1		8	2	1	4	7	1	49	1	39	1	8		6
BCC	441	4	7	1		2	1	11	5	1	49		50	1	9	1	
BMHS	83	12	1		2		1	2	2		5		5	1	4		
CLA	333	1	3	4	1			9	8		36		33	2	5		3
CON	210	7	2		3				2		15	1	23	2	4		3
COR	234	2	4	4	6	1	4	6			25	1	26	2	4		2
CRK	264	3		1	4		1	6	4		22		11		2		1
CTW	2063	30	10	19	39	10	21	22	19			3	199	5	32		20
CVHS	27		2								5		5				
CVPL	852	18	8	3	25	1	2	10	9		92	2		3	16		3
CVUSD	96	10	1		1			1			12		16		3		
DHL	376	6	3	2	5	1	4	5	8		32	1	35	2			7
DIAL	14	1			1						1				1		
ERU	258	2			19	4		3			15		22	1	2		
GMMS	65	9	1		1			3			3		6	3			
JER	298	2	1	2	10	1		4	5		27		18		4		1
LES	73	9						1			8		18		2		
MAY	360	1	6	4	6		5	5	8		33		42	1	4		5
MVS	16	1			3						3		2		2		
ORME	99	5	2		3	1			1		5	1	4	2	1		
PCL	370	1		1	3	2	1	2			48		14		3		1
PCT	4																
PHS	124	4		2	1	2			1		13		4	4	2		
PMH	36	5							1		1		6	2			
PPL	5006	78	31	34	99	12	34	89	76	6	629	6	488	12	97	1	73
PPLX	7																
PVPL	2854	54	27	24	66	23	7	38	54		360	5	311	5	65		27
SED	3795	32	26	15	49	5	10	34	35	5	287	1	230	7	41	1	33
SEL	387	1	4	6	8		1	10	7		48		59	2	5		2
SHM	0																
THS	56	7		1							1		4	3	2		
UNDEFINED	3												0				
VBC	222	4		1	4	1	2	3	6		25		23	2	8		2
VER	865	26	5	7	8	1	6	8	14	1	82	2	71	7	16	1	7
WIL	245		3	4	1			1	3		24		20	1	4		1
WTS	39	8			1	2					2		4		1		
YAR	519	4	7	1	7	1	1	12	13		52		34	1	8		4
YAV	1		1														
YCP	1435	3	1	4	22	3	2	18	2		113		67	2	11		6
YCV	1536	2	2		21	1	3	18	6		73		58		11		6
YFL	6												1				1
YLN	1												1				



Statistics



Items Transited by Library for January 2013																
Station Library →																
Item Library ↓	All	GMMS	JER	LES	MAY	MVS	ORME	PCL	PHS	PMH	PPL	PPLA	PPLX	PVPL	SED	SEL
All		22	120	13	431	7	48	202	220	53	5077	302	0	3930	1799	319
AJS	77			2							12	2		11	1	
ASH	238				7			1		1	61	2		40	21	2
BAG	370				2		3	2	1		76	2		87	19	2
BCC	441		1		20	1	1	3	5		120	4		67	22	6
BMHS	83		1					2	3	2	9			14	2	2
CLA	333	1	1		7		1		2		93	1		55	23	7
CON	210	1	1		5		1	1		1	46	1		41	13	4
COR	234			1	7		1		1		51	3		40	8	2
CRK	264		1		6			2	1	1	73	1		45	13	36
CTW	2063		20		53	1	3	13	12	3	552	34		439	169	31
CVHS	27				1						6			5		
CVPL	852	2			22		1	6	8	1	240	8		184	54	18
CVUSD	96							2	1		22			12	4	1
DHL	376	1	2		12			3			102	2		65	24	7
DIAL	14				1					1	2			2	2	
ERU	258	1			1		2	10	2		81	1		36	20	
GMMS	65		1					1	1	1	14	1		10	1	
JER	298				10		3	1			83			54	25	8
LES	73				2					1	13			11	2	
MAY	360		3				1	3	4	1	94	2		66	19	7
MVS	16								1					1		1
ORME	99				1			2	2	1	23	1		17	8	2
PCL	370		3		1	1	2		17		119	1		32	74	
PCT	4													1	2	
PHS	124	1			2		1	6			28	2		21	9	1
PMH	36								1		7			6	3	
PPL	5006	7	22	3	102	3	12	48	42	9		121	0	1231	566	90
PPLX	7							2			4			1		
PVPL	2854	1	21	1	61		4	16	25	9	875	54			265	26
SED	3795	4	22	1	39		6	28	23	9	845	25		508		27
SEL	387	1		1	6			2			70			77	26	
SHM	0															
THS	56	1								3	18			11	2	
UNDEFINED	3		0						1					0	0	
VBC	222		1		6		2	1		2	42			43	16	2
VER	865		3	2	14			5	5	2	244	6		174	46	16
WIL	245		1		4				2		69	3		55	27	1
WTS	39			1						1	6	4		2		
YAR	519		5		11			5	1		135	2		108	43	9
YAV	1															
YCP	1435	1	8		14	1	3	24	44	4	522	13		216	177	6
YCV	1536		3	1	14		1	13	15		319	6		141	92	5
YFL	6										1			1	1	
YLN	1															

Statistics

Items Transited by Library for January 2013

Station Library →

Item Library ↓	All	SHM	THS	VBC	VER	VOC	WIL	WTS	YAR	YCP	YCV	YFL	YLN
All		0	30	394	859	2191	93	51	327	316	64	37	5
AJS	77				13	1	1		1	1			
ASH	238			5	7	13		1	1	4			1
BAG	370		1	8	16	12	2		5	2			
BCC	441		2	6	16	14	3		2	5	1		0
BMHS	83		1		5	3			2	2			0
CLA	333		1	1	9	8		1	8	6	3		
CON	210				9	11	2	1	4	2			4
COR	234			6	12	4			7	3	1		
CRK	264			3	9	8			3	1		6	
CTW	2063		4	35	79	116	8	6	17	26	5	8	0
CVHS	27				2		1						0
CVPL	852		3	4	38	38	5	2	11	10	3	2	0
CVUSD	96		1	1	3	2		1	2				0
DHL	376			7	13	9			8	8	2		0
DIAL	14				0	2							
ERU	258			1	5	17			4	6	3		0
GMMS	65				5	1	1			1	1		0
JER	298			6	8	10			8	7			
LES	73		1		5								0
MAY	360		1	7	12	9	3		2	6			
MVS	16				1			1					0
ORME	99				10	5				1	1		0
PCL	370			6	5	17	2	2	3	6	3		0
PCT	4											1	
PHS	124			4	6	2	2		3	1	2		
PMH	36				3	1							
PPL	5006		5	109	225	392	24	17	92	106	11	4	0
PPLX	7												
PVPL	2854		5	48	120	167	11	9	37	24	5	4	0
SED	3795		4	64	109	1147	10	5	37	55	12	4	0
SEL	387			6	16	14	3		7	5			
SHM	0	0											
THS	56				3								
UNDEFINED	3											2	
VBC	222				8	9		1	4	2	2		
VER	865		1	22		32	1	2	16	6	4	2	0
WIL	245			2	8	4			5	1		1	
WTS	39				7								
YAR	519			14	11	19	3	1		5		2	
YAV	1												
YCP	1435			16	39	65	6	0	17		4	1	
YCV	1536			13	22	38	5	1	21	14		1	0
YFL	6					1							
YLN	1												



Statistics



Discards January 2013	
Library	Items
All	5246
AJS	3
ASH	74
BAG	151
BCC	124
CLA	733
CON	141
COR	330
CRK	11
CTW	169
CVPL	92
CVUSD	3
DHL	385
ERU	10
GMMS	69
JER	3
MAY	10
MVS	37
ORME	65
PCL	4
PHS	47
PPL	525
PVPL	254
SED	1540
SEL	44
SHM	36
THS	61
VBC	18
VER	195
WIL	4
YAR	21
YCP	55
YCV	31
YFL	1

Items Added January 2013	
Library	Copies
All	7216
AJS	41
ASH	87
BAG	99
BCC	157
BMHS	49
CLA	109
CON	76
COR	108
CRK	42
CTW	812
CVHS	120
CVPL	357
CVUSD	2
DHL	28
DIAL	11
ERU	308
GMMS	35
JER	54
LES	60
MAY	88
MVS	4
ORME	5
PCL	235
PHS	11
PMH	74
PPL	1831
PVPL	429
SED	764
SEL	66
SHM	2
THS	31
VBC	69
VER	99
WIL	35
WTS	40
YAR	281
YAV	90
YCP	328
YCV	104
YFL	62
YLN	13

Statistics

New Users January 2013	
Library	Patrons
ALL	1702
AJS	5
ASH	15
BAG	5
BCC	18
BMHS	35
CLA	7
CON	16
COR	13
CRK	1
CTW	171
CVHS	18
CVPL	66
CVUSD	34
DHL	22
ERU	34
GMMS	10
JER	5
LES	5
MAY	7
MVS	7
ORME	8
PCL	124
PHS	25
PMH	6
PPL	404
PVPL	318
SED	134
SEL	7
THS	7
VBC	15
VER	69
VOC	20
WIL	2
WTS	10
YAR	11
YCP	39
YCV	9

Patron Bills by Library for January 2013							
Bill Library	Number of Bills	Total Amount Billed	Payment Amounts	Patrons with Bills	Delinquent Patrons with Bills	Blocked Patrons with Bills	Barred Patrons with Bills
ALL	10794	43429.69	42556.64	3269	826	274	39
AJS	13	97	97	6	0	0	0
ASH	34	303.38	303.38	10	0	0	0
BAG	77	691.44	691.44	15	2	3	0
BCC	34	316.1	316.1	6	2	3	0
BMHS	506	9177.27	9120.66	134	0	35	4
CLA	10	18.8	18.8	8	4	1	0
CON	35	120.5	120.5	13	5	1	0
COR	17	100.8	100.8	6	1	0	0
CRK	3	28.75	28.75	2	0	1	0
CTW	1778	3409.64	3247.18	510	131	30	2
CVHS	4	269.6	269.6	2	0	1	0
CVPL	429	696.37	651.87	146	36	7	0
CVUSD	60	536.86	536.86	27	5	2	0
DHL	9	74.15	74.15	4	3	0	0
DIAL	2	1	1	1	1	0	0
ERU	52	494.41	494.41	24	2	3	0
GMMS	58	198.53	196.73	48	0	14	0
JER	68	717.05	717.05	13	4	4	0
LES	28	317.45	317.45	25	16	1	0
MAY	21	53.85	53.85	9	3	1	0
MVS	4	45.45	45.45	4	1	0	0
ORME	50	538.62	538.62	22	7	3	0
PCL	323	2608.23	2580.23	72	7	5	0
PHS	103	1264.49	1263.74	53	2	6	0
PMH	107	292.63	275.13	63	1	22	0
PPL	2230	7471.65	7158.11	714	205	51	12
PPLA	9	10.5	10.5	8	1	0	0
PPLG	5	8	6.7	4	1	0	0
PVPL	1585	4349.44	4252.37	409	130	35	15
SED	2025	3512.28	3438.89	668	213	21	3
SEL	51	516.2	516.2	13	4	2	0
THS	61	591.48	591.48	31	9	1	0
VBC	48	386	386	14	2	1	0
VER	377	948.59	940.55	113	32	8	5
VOC	136	86.3	85.8	69	14	0	0
WIL	50	473.55	473.55	16	4	1	0
WTS	35	562.49	543.99	21	5	5	0
YAR	7	57	57	4	1	0	1
YCP	269	1553.24	1539.26	66	20	6	0
YCV	62	265.6	265.12	23	4	4	0
YFL	1	15	15	1	0	0	0
YLN	18	250	215.37	15	0	3	0



Statistics



Circulation by Library for January 2013 (Circulation Total does not include Lib Use Trans)						
Library	Checkouts	Staff Renewals	Patron Renewals	Use Item	Library Use Transactions	Total Circulation
All	171539	10724	18870	4579	13787	206005
AJS	2944	0	8		569	2952
ASH	1045	27	20		207	1092
BAG	556	61	35		212	652
BCC	2314	180	35		200	2529
BMHS	1103	119	9		31	1231
CLA	879	79	79		982	1037
CON	1324	125	93		164	1542
COR	1554	98	46		344	1698
CRK	395	70	9		22	474
CTW	16528	1199	1821	335	770	19883
CVHS	363	113	1		39	477
CVPL	8184	793	899		278	9876
CVUSD	2810	119			9	2929
DHL	1549	68	143		432	1760
DIAL	7				0	7
ERU	858	106	85	72	83	1368
GMMS	532	0		106	108	638
JER	871	122	19		96	1012
LES	1930	3		261	78	2194
MAY	2079	93	99		112	2271
MVS	1135	36			43	1171
ORME	90	33	12		72	135
PCL	899	218	201	119	66	1437
PHS	637	40			54	677
PMH	579	0		84	168	663
PPL	50667	3086	8189		2298	61942
PPLA	302	6	23		5	331
PPLX	0				1	
PVPL	32188	893	3499	2235	1938	38815
SED	19272	699	1736	359	2504	22066
SEL	1665	40	7		54	1712
SHM	0				36	
THS	1757	489		76	245	2322
VBC	2300	67	99		142	2466
VER	3857	285	592		428	4734
VOC	2191	71	224		31	2486
WIL	438	22	22		23	482
WTS	1305	146		73	41	1524
YAR	2018	243	79		106	2340
YCP	1689	207	593	656	621	3191
YCV	674	192	36	203	33	1105
YFL	46	12			5	58
YLN	5	564	157		137	726



Statistics



Checkins by Library for January 2013		
Library	Total	Change Vs. Previous Year FY July June
All	171333	4%
AJS	2701	-29%
ASH	1166	46%
BAG	689	-19%
BCC	2517	-11%
BMHS	935	6%
CLA	1195	-9%
CON	1532	29%
COR	1841	-5%
CRK	375	-40%
CTW	16375	6%
CVHS	279	-34%
CVPL	8376	7%
CVUSD	2061	2%
DHL	1421	24%
DIAL	3	-93%
ERU	962	15%
GMMS	506	-12%
JER	871	11%
LES	1897	-7%
MAY	2464	14%
MVS	835	-2%
ORME	137	27%
PCL	735	-11%
PCT	12	-71%
PHS	538	-26%
PMH	289	-62%
PPL	49493	15%
PPLA	4	
PPLG		-100%
PPLX	1	
PVPL	31463	3%
SED	19335	8%
SEL	1565	14%
THS	1807	-46%
VBC	2333	26%
VER	4709	0%
VOC	2762	7%
WIL	692	-9%
WTS	1165	-32%
YAR	2181	13%
YCP	2218	7%
YCV	821	21%
YFL	47	18%
YLN	25	2400%



Statistics



OPAC Searches by Library for January 2013							
Library	Number of Searches	Number of Hits	Average Hits Per Search	Sessions with Searches	% of Total-YLN Searches	Add'l Extrap. Searches	Est. Tot. Searches
All	114981	38260777	332.757386	42473			
(Blank)	8	5	0.625	2	0.01%	6	14
AJS	768	494198	643.4869792	239	1.19%	601	1369
ASH	277	91563	330.5523466	50	0.43%	217	494
BAG	138	36158	262.0144928	45	0.21%	108	246
BCC	431	61986	143.8190255	109	0.67%	337	768
BMHS	198	29879	150.9040404	44	0.31%	155	353
CLA	362	21811	60.25138122	102	0.56%	283	645
CON	499	164941	330.5430862	135	0.77%	390	889
COR	249	28729	115.37751	54	0.39%	195	444
CRK	32	15498	484.3125	12	0.05%	25	57
CTW	6548	1969334	300.7535125	1969	10.15%	5120	11668
CVHS	84	6508	77.47619048	27	0.13%	66	150
CVPL	5404	1917221	354.7781273	1342	8.37%	4226	9630
CVUSD	60	7574	126.2333333	25	0.09%	47	107
DHL	573	144926	252.9249564	149	0.89%	448	1021
ERU	276	130304	472.115942	73	0.43%	216	492
JER	168	4934	29.36904762	73	0.26%	131	299
LES	24	3411	142.125	7	0.04%	19	43
MAY	388	57172	147.3505155	121	0.60%	303	691
ORME	75	2208	29.44	32	0.12%	59	134
PCL	243	28736	118.255144	77	0.38%	190	433
PHS	370	100173	270.7378378	119	0.57%	289	659
PMH	60	4090	68.16666667	27	0.09%	47	107
PPL	21410	5593679	261.2647828	6694	33.18%	16741	38151
PPLA	192	4688	24.41666667	42	0.30%	150	342
PVPL	11722	5344291	455.9197236	3446	18.17%	9166	20888
SED	8082	2453205	303.5393467	2682	12.53%	6320	14402
SEL	226	15115	66.88053097	47	0.35%	177	403
THS	15	583	38.86666667	10	0.02%	12	27
VBC	287	114172	397.8118467	74	0.44%	224	511
VER	1680	308453	183.6029762	550	2.60%	1314	2994
VOC	1532	278415	181.7330287	470	2.37%	1198	2730
WIL	113	3679	32.55752212	38	0.18%	88	201
WTS	175	25087	143.3542857	22	0.27%	137	312
YAR	322	41772	129.7267081	96	0.50%	252	574
YCP	1164	581284	499.3848797	353	1.80%	910	2074
YCV	367	34266	93.36784741	113	0.57%	287	654
YFL	4	105	26.25	1	0.01%	3	7
YLN	50455	18140624	359.54066	23172			
Total-YLN	64526				100.00%		



From: **01/2013 to 01/2013**
 Detailed by: **Entire Period**
 For: **Yavapai Free Library District (yln)**
 Category: **All Categories**
 Usage Type: **All Documents Selected**

Entire Period	Category	Subcategory	Pages Viewed	Pages Copied	Pages Printed	Unique Documents	Wait Queue	Online Turnaways	Chapter/Range Downloads	Full Title Downloads
Entire Period	BUSINESS & ECONOMICS	Finance	16	.	.	1	0		2	.
	FICTION	Suspense	47	.	.	1	0		.	.
	HEALTH & FITNESS	Diets	74	.	.	1	0		.	.
	HISTORY	United States / Colonial Period (1600-1775)	5	.	1	1	0		.	.
	RELIGION	Philosophy	5	.	.	1	0		.	2
	SCIENCE	Cosmology	6	.	.	1	0		.	1
	SOCIAL SCIENCE	Agriculture & Food	2	.	.	1	0		.	.
TOTAL			155	0	1	7	0		2	3

Statistics - Overdrive

Digital Library Statistics

From 1/1/2013 through 1/31/2013 | Select Date Range

Collection details from inception to 1/31/2013

Purchased Titles in Collection: 5,913
 Audiobook: 2,842
 eBook: 3,071

Purchased Copies in Collection (counting each copy of each format of a title): 6,662
 Audiobook: 3,125
 eBook: 3,537

Licensed eBooks in Collection: 113
 eBook: 113

Other details from 1/1/2013 through 1/31/2013

Checkouts: 6,790
 Audiobook: 1,974
 eBook: 4,816

Holds: 2,555
 Audiobook: 647
 eBook: 1,908

Unique Library Patrons Checking Out Titles: 1,613



Statistics - I-Tiva (TM3)



Date	Messages Imported	Messages Rejected	Calls Made	Number of Deliveries	Patron Logins on MESSAGE call
1/1/2013					
1/2/2013					
1/3/2013					
1/4/2013					
1/5/2013					
1/6/2013					
1/7/2013					
1/8/2013					
1/9/2013					
1/10/2013					
1/11/2013					
1/12/2013					
1/13/2013					
1/14/2013					
1/15/2013					
1/16/2013					
1/17/2013					
1/18/2013					
1/19/2013					
1/20/2013					
1/21/2013					
1/22/2013					
1/23/2013					
1/24/2013					
1/25/2013					
1/26/2013					
1/27/2013					
1/28/2013					
1/29/2013					
1/30/2013	6	2	6	5	
1/31/2013	210	6	259	187	
Grand Total:	216	8	265	192	

January is a partial month due to the upgrade.